

# SURENDRAN CONSULTING STRUCTURAL ENGINEERS

## LETTER OF TRANSMITTAL

DATE: June 1, 2009
JOB NUMBER: 09023
RE: CLASS ROOM ADDITIONS, GRADY INDEPENDENT SCHOOL DISTRICT, LENORAH, TEXAS

TO:  
Grimes and Associates  
P.O. Box No. 65  
Wolfforth, TEXAS 79382

Attn: Mr. Bert Moffitt, AIA, Mr. Craig Ray, Architect Intern, Mr. Joe Grimes, P.E.

We are sending you the following items:

- |   |   |  |
|---|---|--|
| <input type="checkbox"/> SHOP DRAWINGS    | <input type="checkbox"/> SAMPLES        | <input checked="" type="checkbox"/> ATTACHED       |
| <input type="checkbox"/> PRINTS           | <input type="checkbox"/> SPECIFICATIONS | <input type="checkbox"/> UNDER SEPARATE COVER VIA: |
| <input checked="" type="checkbox"/> PLANS | <input type="checkbox"/> COPY OF LETTER |  |
| <input type="checkbox"/> CHANGE ORDER     | <input type="checkbox"/> OTHER:         |  |

COPIES	DATE	NO	DESCRIPTION
ONE	06-01-09		SUPPLEMENTARY DRAWING NO. 32

These are transmitted as checked below:

- |  |   |   |
|--|---|---|
| <input type="checkbox"/> FOR APPROVAL            | <input type="checkbox"/> APPROVED AS SUBMITTED            | <input type="checkbox"/> RESUBMIT _____ COPIES FOR APPROVAL   |
| <input checked="" type="checkbox"/> FOR YOUR USE | <input type="checkbox"/> APPROVED AS NOTED                | <input type="checkbox"/> SUBMIT _____ COPIES FOR DISTRIBUTION |
| <input type="checkbox"/> AS REQUESTED            | <input type="checkbox"/> RETURNED FOR CORRECTIONS         | <input type="checkbox"/> RETURN _____ CORRECTED PRINTS        |
| <input type="checkbox"/> FOR REVIEW & COMMENT    | <input type="checkbox"/> PRINTS RETURNED AFTER LOAN TO US | <input type="checkbox"/> FOR BIDS DUE                         |
| <input type="checkbox"/> OTHER:                  |   |   |

Remarks:

RFI No. 2. Use W16x26. Please note that since the span is about 52', in order to utilize a lighter beam, it is required to use intermediate hangers. This will be cost effective than using a heavy beam that spans 52'  
RFI No. 3. Use W21x44.

If you have any questions, please call me

FROM: C.V. Surendran, P.E.

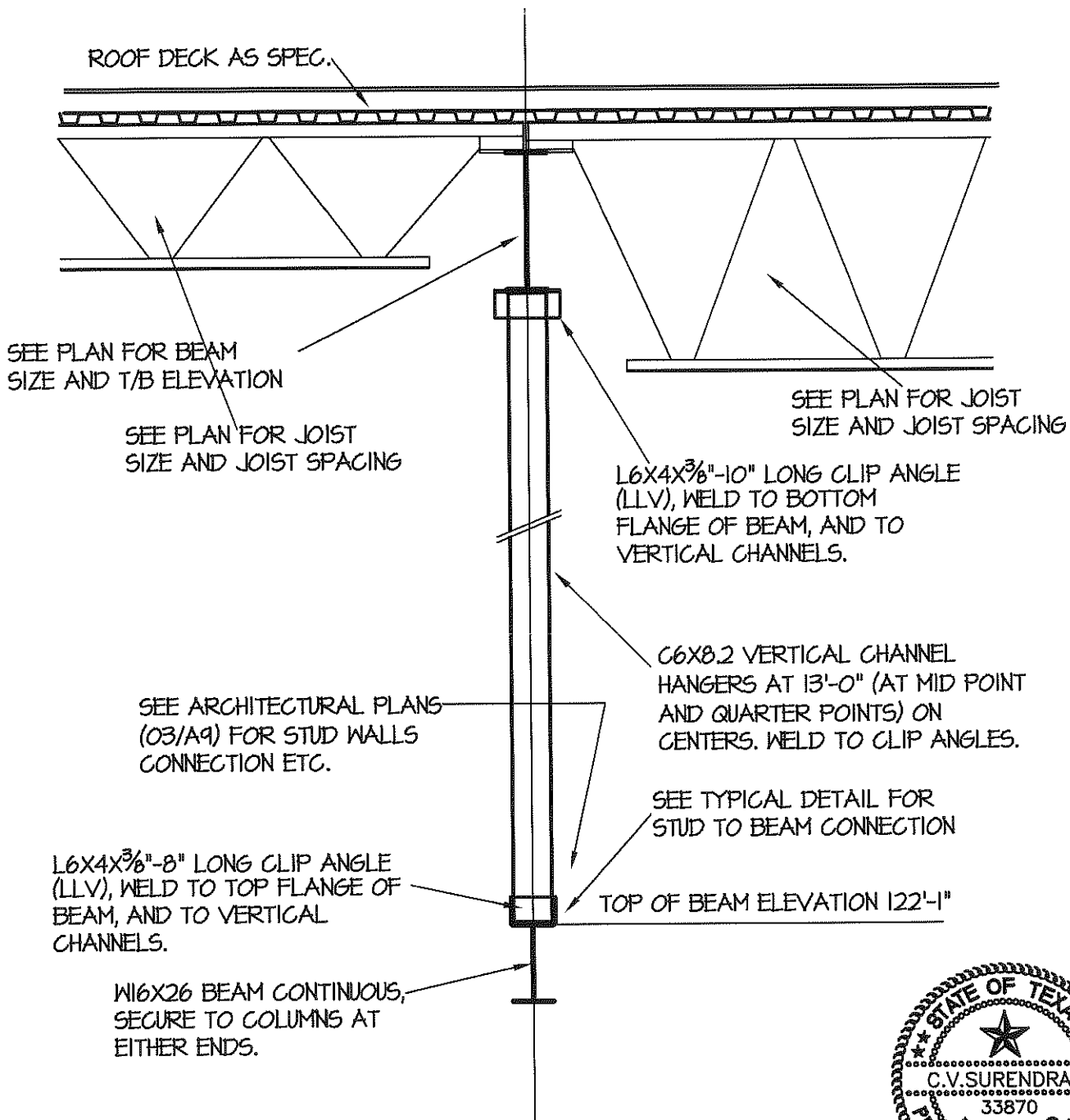

**SECTION**

**04-SD**

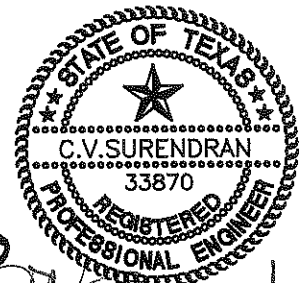

*C.V. Surendran*  
6-1-09

**SUPPLEMENTARY DRAWING NO. 33**

HIGHLAND IND. SCHOOL DISTRICT, RASCOE, TEXAS  
YEAR 2009 IMPROVEMENTS-HIGH SCHOOL ADDITION PH.I.

	<b>SURENDRAN CONSULTING STRUCTURAL ENGINEERS</b>
	8107 Kenosha Avenue Lubbock, TX 79423-1723 www.surendranconsulting.com
	Phone: 806.793.8668 Fax: 806.795.1582

SHEET NO. 1 OF 1  
DATE: JUNE 01, 2009